

OPERATING INSTRUCTIONS

⚠ WARNING

- Keep burner at arm's length, away from face, during ignition. Flame can flare during ignition.
- Do not attempt to light with included pot or any other cookware on the burner. Gas build-up can occur, resulting in increased flame eruption.
- Never expose stove to flammable vapors or liquids while lighting the burner. It can cause an explosion or fire.
- Do not heat empty pot. Product will melt and potentially catch fire.
- Do not move, lift, or tilt stove with lit burner. Product damage or injury can occur due to flaring.
- Do not fill above maximum fill line. This may cause boil-over, resulting in injury.
- If attempting to heat anything other than water, use care and stir frequently to avoid boil over or scorching, which may result in product damage or injury.
- Always check that the burner is extinguished before disconnecting the fuel canister.
- Do not use for boiling oil or deep frying. Product damage or injury can occur due to overheating.

Preparation:

1. Remove bottom cover (7.1) from bottom of the Jetboil pot (7.2). 2. Remove Pot Support Warning Tag. 3. Add contents to the pot, cover with lid, but do not put the pot on the stove yet. Now you are ready to light the burner.

NOTICE Performance may be suboptimal if used in extreme conditions (cold, hot, wind, altitude).

⚠ WARNING Do not use stove to warm fuel canister. Can result in explosion.

Lighting the Burner:

⚠ CAUTION Ensure burner base is free of any pot prior to lighting. Gas build-up can occur, resulting in increased flame eruption.

1. Hold lit match or lighter over top of burner (Fig 9).
2. Open control valve (6.1) counterclockwise until burner is lit.

Usage:

1. If necessary, rotate control valve (8.1) clockwise to decrease flame setting.
2. Once the burner is lit, carefully place the pot with its contents on the burner base (Fig 10); turn as shown in Fig 11 to lock into place.

⚠ CAUTION Use care when removing lid. Steam and/or contents may be hot and can cause injury.

After Use:

1. Turn off control valve (8.1) (tighten clockwise) to extinguish flame. 2. Remove pot from burner base – hold pot by cozy (10.1), and base by shroud (10.2).

⚠ WARNING Exposed metal parts will be hot and may cause injury if touched.

3. Always disconnect fuel canister after use. Unscrew fuel canister from burner base (Fig 4), and replace plastic fuel cap.

⚠ WARNING Always check that the burner is extinguished before disconnecting the fuel canister. Vapors can ignite and cause serious injury.

Packing:

1. Allow stove to fully cool before packing. 2. Place bottom cover (7.1) on pot (7.2).
3. Remove stabilizer from canister and fold for storage (1.2). 4. If using the pot support: Remove pot support from burner base (Fig 12), and fold legs (1.4). 5. Refer to Fig 1 for packing contents into pot.

Storage After Use:

1. Always disconnect fuel canister before storing the stove. 2. Ensure stove and pot are clean and dry before storing. 3. Store the stove in a cool, dry location, indoors.

Maintenance:

1. **Flame Check (Every use):** The height of the flame should increase from low to high with counter-clockwise rotation of the control valve. Flame should be blue with no yellow tipping at full output. Flame should not flash back into burner or lift off of burner top. If flame abnormalities are found, see your dealer or contact Jetboil for service. 2. **Cleaning Pot (before storage, or as needed):** Allow pot to cool before cleaning. Do not use a dishwasher or abrasive compounds (sand, salt, etc.) to clean. Only wash by hand with soapy water.

Troubleshooting:

1. **Flame does not extinguish:** Tighten valve as much as possible, blow out flame, and immediately detach fuel source. See your dealer or contact Jetboil for service.
2. If an issue cannot be corrected using these instructions, see Limited Warranty on back page.



LOWER FLAME AS NEEDED

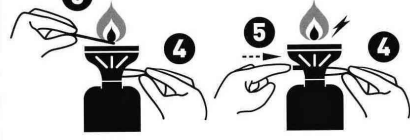

OPEN VALVE FULLY AND IGNITE

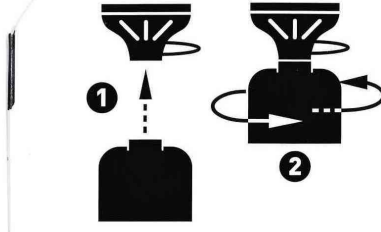

CONNECT AND SECURE FUEL CAN

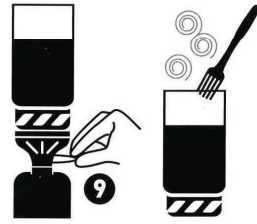

TURN OFF FLAME. REMOVE POT. ENJOY!

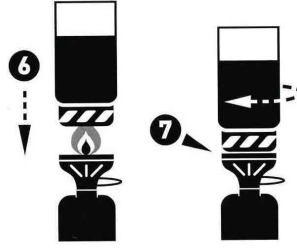

PLACE POT ON BURNER AND ROTATE TO LOCK INTO PLACE



ADD WATER OR CONTENTS TO POT

